



# Bio-Canvas Installation Guide

Bio-Canvas installations are best accomplished with a minimum of two people.

## COMPONENTS

There are 3 frames sizes:

Safety clips and Wall Fasteners (\*Drywall Standard) are provided with panels



12" x 24"



24" x 24"



24" x 48"

Acoustic Moss Panels  
(3 available sizes)



Lime  
Green Moss

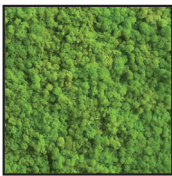

Medium  
Green Moss



Forest  
Green Moss

Pole Moss  
Panel  
(1 available size)



Pole  
Moss

Sustainable  
Bark Panels  
(2 available sizes)



Upcycled  
Coconut Bark

Light Stone Panels  
(2 available sizes)



Prairie Brown



Mountain Grey

## TOOLS

Stud Finder, Level, Pencil, Tape Measure, Punch, Screw Driver, Electric Drill, Drill Bits and Drivers, Hammer, Rubber Mallet (Optional).

## INSTALLATION

The frames can be mounted flush against one another or spaced apart from one another.



The back of the frame  
mounts on the wall

Two piece frame



The front of the frame  
snaps onto the back frame



## STEP 1: IDENTIFYING THE LOCATION OF THE BIO CANVAS ON THE WALL

Identify the size of your Bio Canvas frame/frames before selecting the wall you want to mount it on. If the frames are to be separated from one another, each frame must be located individually. If the frames are to be flush with one another, the first frame will determine the location of the other frames.

ALL BACK FRAMES MUST BE INSTALLED BEFORE INSERTING PANELS, SAFETY CLIPS AND FRONT FRAMES.

## STEP 2: INSTALLING THE FIRST BACK FRAME

A. Installation can be done from left to right. The first frame will be the bottom left frame. Using a level and a pencil, make a vertical line where the left side will go and a horizontal line where the bottom will go.



B. Using the stud finder, check and mark the location of studs to determine what kind of fastener to use, e.g, anchors for drywall, self-tapping metal screws for aluminum studs, lag screws for wood studs.

C. **Drywall Install:** Locate the first back frame against the two lines. One person holds the frame in place, keeping an eye on the level, which is placed on top of the frame. When both installers agree the frame is in the correct location, the person not holding the frame marks the 4 spots for the fasteners using a pencil or a punch. The punch is most useful in drywall installs because it makes a good starter hole for the drill.

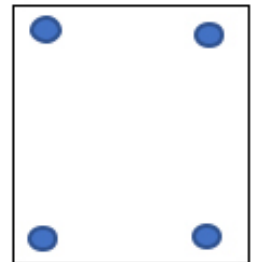

Take the frame away from the wall and drill starter holes for the drywall anchors using 1/8" bit.

Place the frame back on the wall and partially screw in all 4 screws. Put the level on the top of the frame, level the unit. One person holds the unit in the level position while the other finishes tightening the screws.



**D. Going into Studs:** When the hole is located over a stud use the electric drill and the correct size driver to drive a self-tapping metal screw into aluminum studs, or a lag screw into wood studs. Use caution not to over tighten so as not to damage the frame.

### STEP 3: INSTALLING THE REST OF THE BACK FRAMES

#### A. FLUSH MOUNT INSTALLATION

Proceed vertically or horizontally from the first back frame to complete the installation. Line up the next back frame with the first back frame, then follow the instructions in Step 2, then proceed to the next back frame.

#### B. SPACE BETWEEN FRAMES

If your design requires a space between frames, make sure to measure and mark the lines for the next frame as done in Step 2, then attach the next back frame as in Step 2. Repeat the process with the next frame.



## STEP 4: INSTALLING THE INSERTS, SAFETY CLIPS AND FRONT FRAMES

First, Place the insert into the back frame. Next, install the safety clips in the indented locations around the edges of the back frame. Finally, snap the top frame securely onto the back frame. **Always check to make sure the front frame is tightly connected before moving on, also fully complete the installation for one frame before moving onto another frame.**

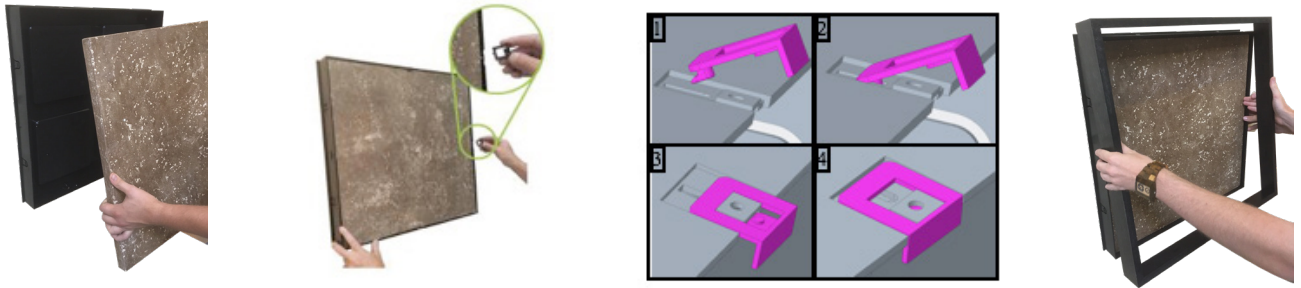

**NOTE:** When installing moss panels into the frames make sure no excess moss is hanging over the back frame. If excess moss exists, please push it towards the back frame to insure the moss does not interfere with the snapping of the frame. Pole Moss is delicate. Be careful and do not push too hard down on the moss while installing the frame.

## STEP 5: CHANGING THE INSERTS

First, place your fingers near one of the snap locations and give a sharp pull on the top frame. This will release it from the back frame. Finish removing the front frame and hand it to another person or put it down. Next, carefully remove the safety clips and the insert, then hand them to another person or put them down. Then change the insert by following the steps in Step 4.



**NOTE:** Make sure you have an extra supply of Safety Clips for this operation as the clips do not always survive the removal process.

**IMPORTANT:** All Bio Canvas panel inserts are designed to insure that they function properly in our Bio Canvas frames. Should you decide to use panel inserts of your own design in our frames, we cannot guarantee that our frames will function properly with these inserts unless you send them to us for testing. If approved, we will keep the samples in our warehouse for future reference.